



BPme rewards

registration guide for Android



How do I find the BPme App in the Google Play Store?

1. Open the **Google Play Store** by clicking on the icon.
2. The Google Play Store homepage will appear.
3. On the homepage, select '**Search**' and type **BPme or BPme app**.
4. Click '**Install**.' Once download is complete, click '**Open**' and the BPme app will open.

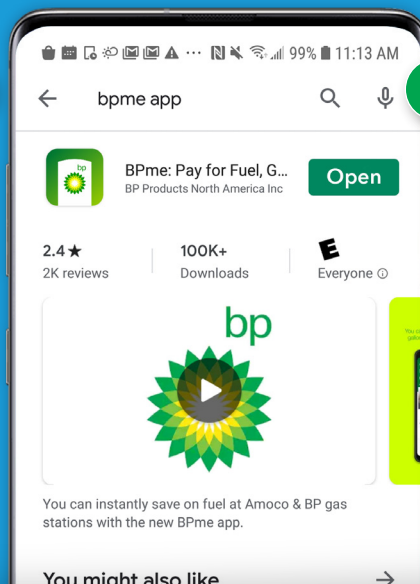
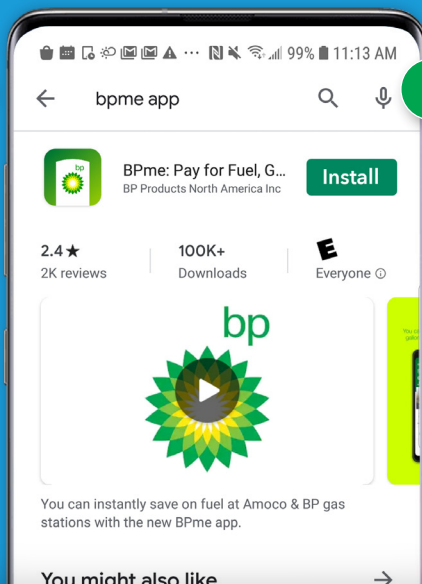
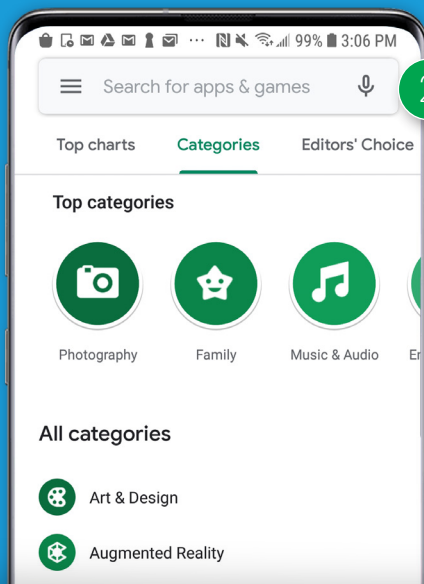



BPme Rewards registration guide for Android

(continued)

How do I register for BPme Rewards once I've downloaded the BPme app to my phone?

1. **Locate and tap the BPme app icon** on your phone.
2. Once the application opens, **tap 'Register.'**
3. A safety message will appear advising you to only use BPme inside your stationary car. **Click 'Accept.'**
4. **Enter your first and last name** into the section listed NAME.

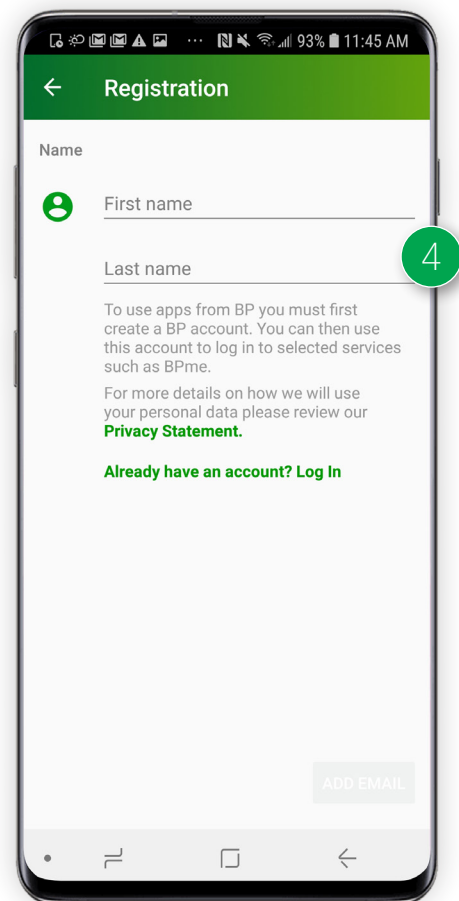
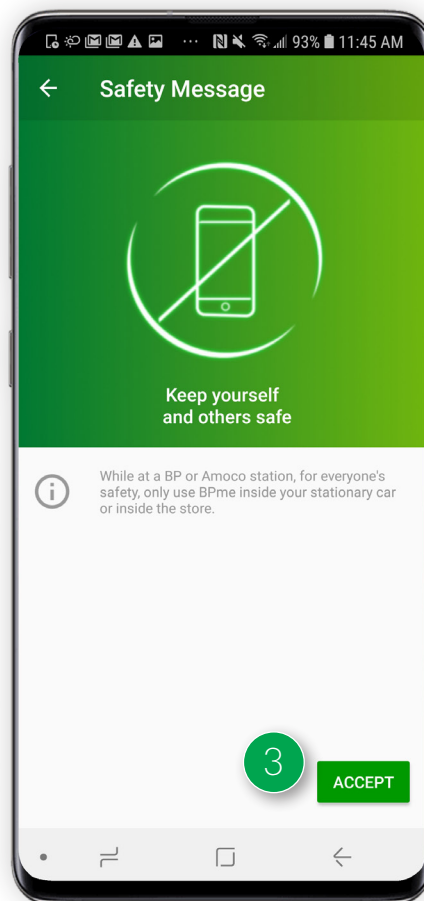
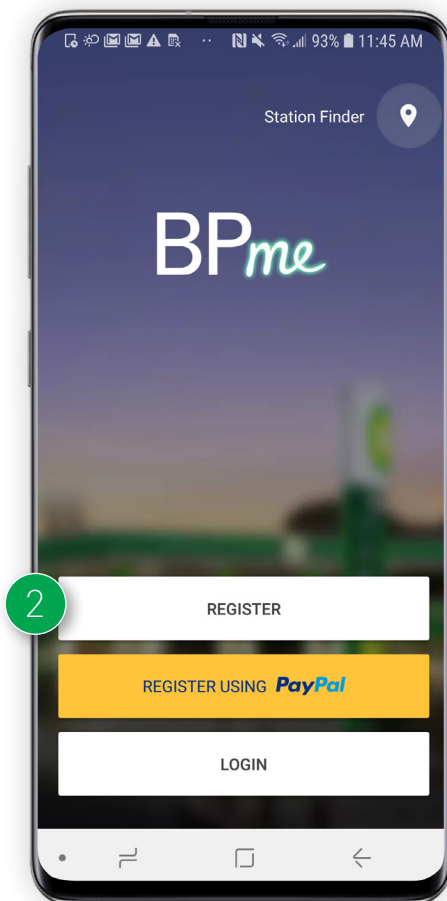



BPme Rewards registration guide for Android

(continued)

5. Enter your email address and then **check both the 'Terms & Conditions' box** as well as the **'Privacy Statement' box**. The 'Confirm' button will change from Gray to Green. **Click 'Confirm.'**
6. The app will prompt you to check your email. Go back to the homescreen of your phone. **Check the email address** that was just entered into BPme for registration for next steps.

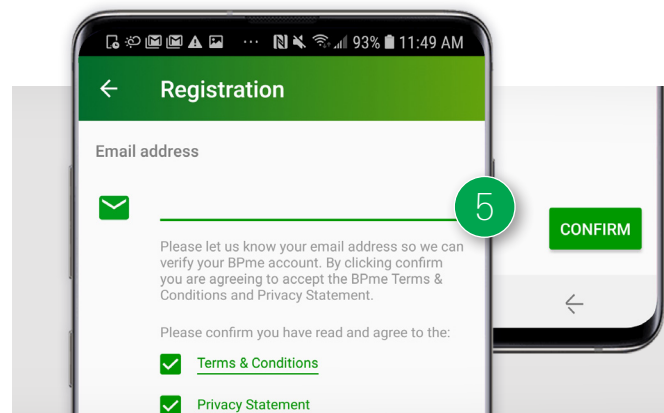

7. Once you open your email, you will find an email titled 'Welcome to BP.' **Click 'Verify.'** This will generate a prompt to create a password.
8. Your password must be at least 10 characters long. Your password must include numbers and uppercase and lowercase letters. **Type your password** into both boxes then **click 'Confirm Password.'**

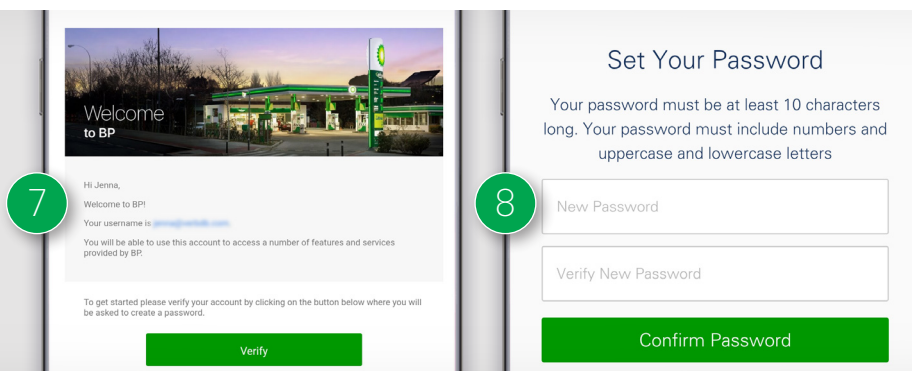
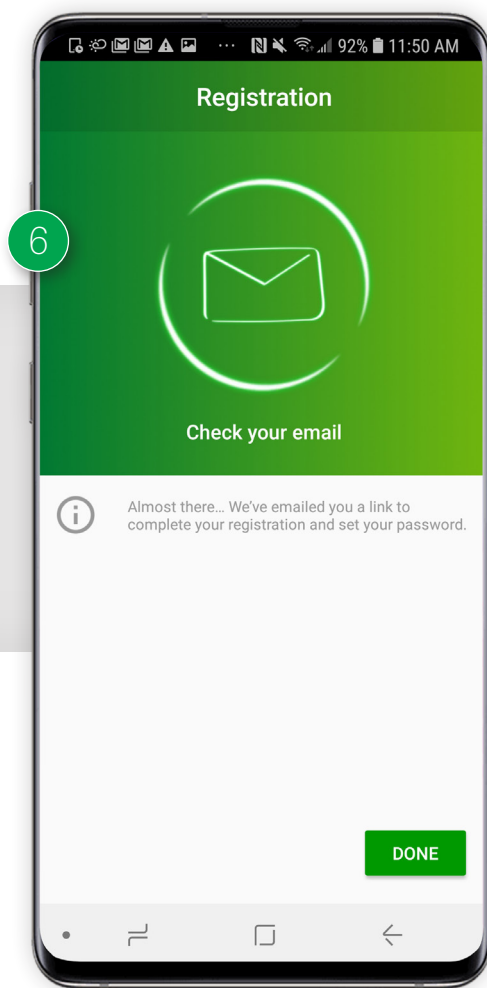

NOTE: If you are validating your email and setting your password on a laptop or desktop computer, you will see a page that says "App Launcher" once you set your password. This is not an error page, it just indicates that your password is set up. From here you will go back to the BPme app to log in.



BPme Rewards registration guide for Android

(continued)

9. From the homescreen, re-launch the BPme app and click **'Log in.'**
10. Enter the email address and password you just setup. Then **press 'Log in.'**
11. The first time you log in, you will be asked to **verify your identity.** Check your inbox for an email titled 'Verify your identify in BP.'
12. Enter the **5-digit verification code** provided in the email and **click 'Verify.'**

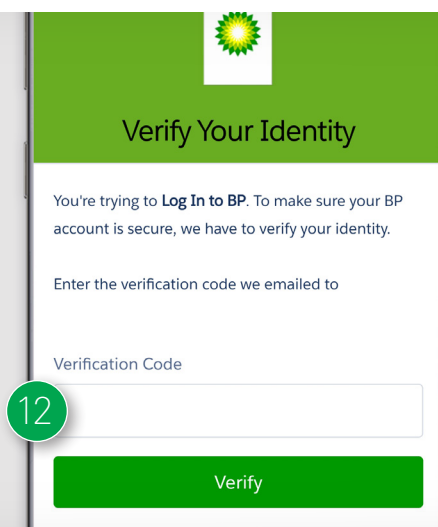
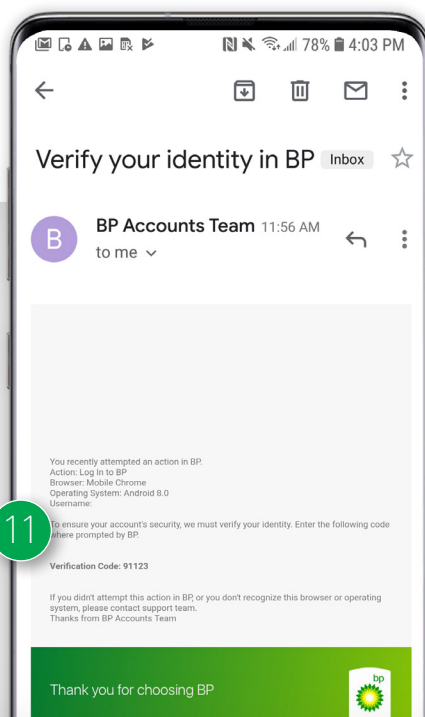
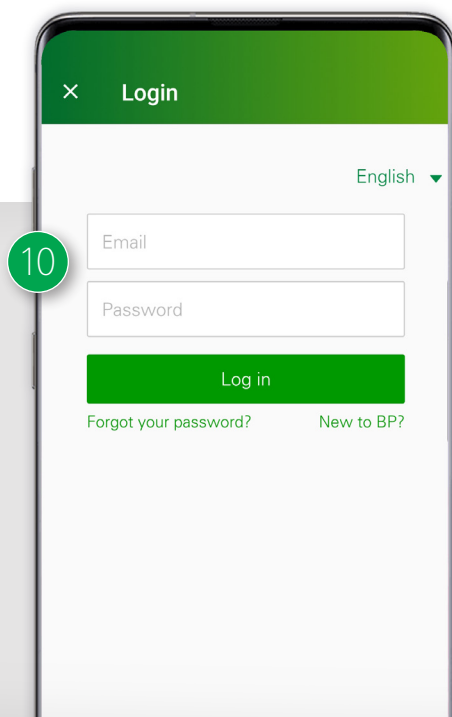
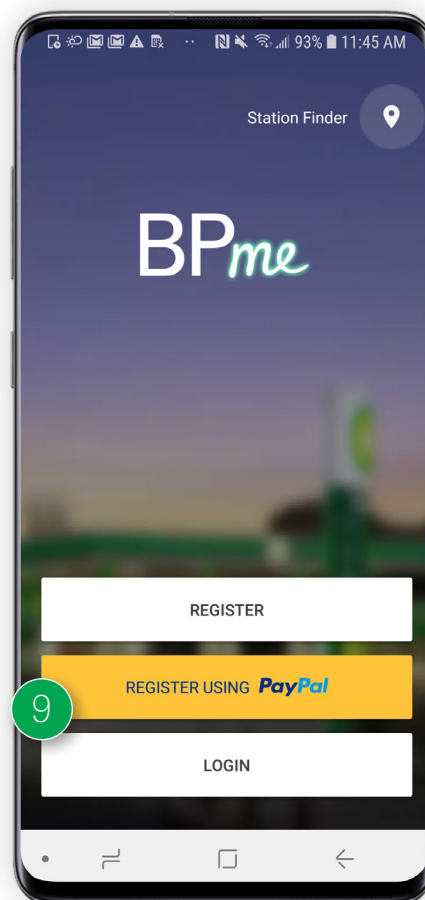



BPme Rewards registration guide for Android

(continued)

13. There are four steps for security setup:

- Enter your mobile phone number** into the box. Once your phone number is entered, the 'Send Verification Code' box will update from gray to green and you will be able to click it. **Click 'Send Verification Code.'**
- Enter the 4-digit code** that was texted to your phone. The 'Verify' box will update from gray to green and you will be able to click it. **Click 'Verify.'**
- Select a security question** and **enter your answer** into the box. The question will be asked when you are activating your BPme account from new devices. **Click 'Set PIN' when complete.**
- The last step in Security Setup is to **select a 4-digit PIN number**. Enter the PIN of your choice in the pinpad of your phone. The prompt will have you **enter the 4-digit PIN number twice**.

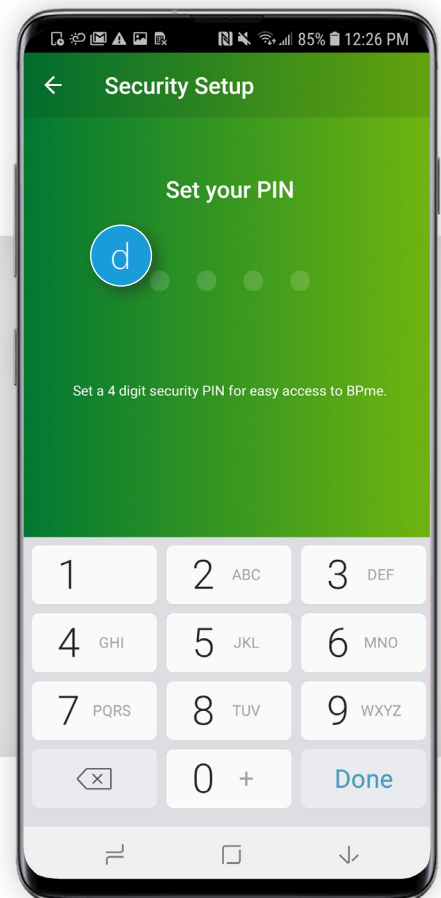
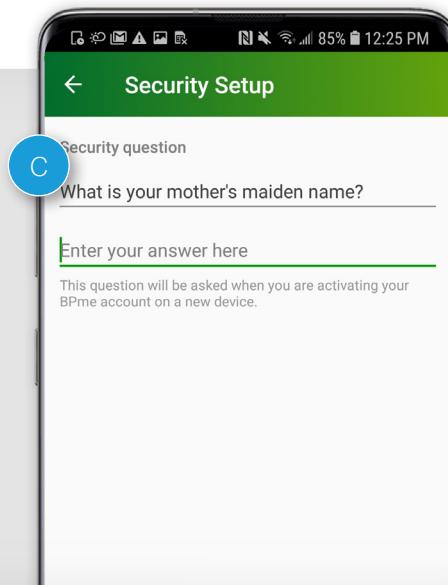
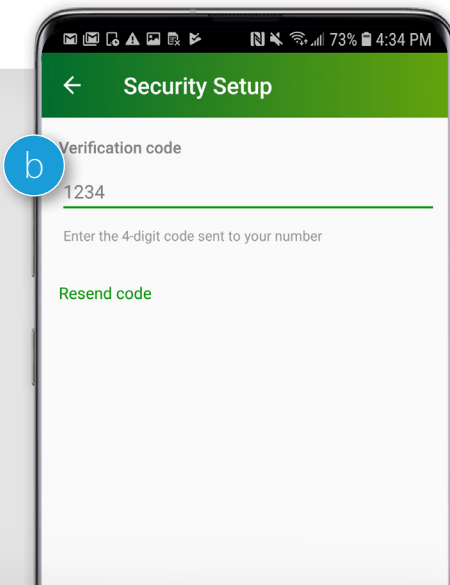
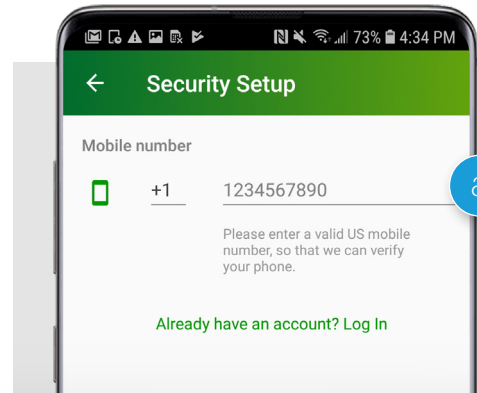



BPme Rewards registration guide for Android

(continued)

14. Make your communication selections - **check 'email me about rewards and updates'** and/or **'text me about rewards/updates'** to get the most out of BPme.
15. Click **'Enable Location Services.'** This allows the app to help find nearby stations and check you in at the station to pay for fuel. Click **'Allow'** when pop-up comes up.
16. Great job! **You are officially registered for BPme Rewards!**

